



### W&O EUROPE

T. +31 164 21 24 20  
E. sales@woeurope.com

www.wosupply.com

### W&O ASIA

T. +65 31632986  
E. sales@woasia.com

### W&O US/CANADA

T. +1 904 354 3800  
E. sales@wosupply.com

## GLOBE VALVE - STRAIGHT

SCREWED BONNET

BRONZE - BRONZE TRIM

STOP TYPE

SECURED BONNET

W&O ITEM CODE : **993304**

DN15~100 / PN16

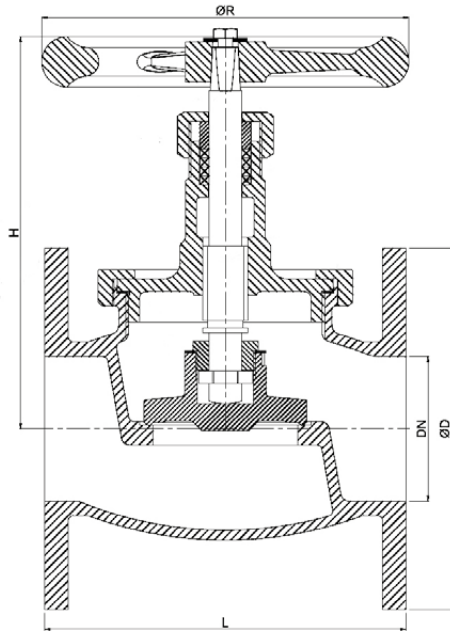

### DIMENSIONS

DN (mm)	Flange conn.	ØD (mm)	L (mm)	H (open) (mm)	ØR (mm)	PCD (mm)	N°holes (Ømm)	Weight (Kg)
15	PN16	95	70	102	63	65	4xØ14	1.5
20	PN16	105	80	117	80	75	4xØ14	2.3
25	PN16	115	90	124	80	85	4xØ14	3
32	PN16	140	105	130	90	100	4xØ18	5
40	PN16	150	120	147	100	110	4xØ18	6.5
50	PN16	165	140	172	125	125	4xØ18	8
65	PN16	185	180	230	160	145	4xØ18	13
80	PN16	200	200	250	200	160	8xØ18	17
100	PN16	220	230	250	200	180	8xØ18	21

### APPLICATION

Hot and cold water, seawater, waste water, oil, air, steam and gases.

### MATERIAL SPECIFICATION

<b>Body</b>	RG5	Bronze
<b>Bonnet</b>	RG5	Bronze
<b>Seats</b>	RG5	Bronze
<b>Disc</b>	RG5	Bronze
<b>Stem</b>	Som59	Brass
<b>Bolts, nuts</b>	A2	Steel
<b>Bonnet gasket</b>	C	Graphite
<b>Gland packing</b>	C	Graphite

### TECHNICAL SPECIFICATIONS

<b>Design</b>	Special design, STOP type
<b>Face to face</b>	Acc. to mentioned dimension table
<b>Flange dimension</b>	DIN Flanges acc. to EN 1092-3/A (DIN 2501)
<b>Flange options</b>	PN16

### PRESSURE & TEMPERATURE RANGES

BORE	PRESS. RATING	Working press.[bar]		Hydro test press.[bar]	
		120°C	CASING	CLOSURE	
DN15~100	PN16	16	24	17.6	

